



COATED COLD PEEL PAPERS

SCREEN PRINTING

“T75”, “T105”, “Z95”, & “TEXTURED”

PRINTING METHOD

- Screen printing of one colour + adhesive layer or powder (T75, Z95)
- Screen printing of one or several colours + adhesive layer or powder (T105, Textured)
- Please note that Z95 is not suitable for water based inks

MAIN ADVANTAGES

- No curling
- Good dimensional stability
- Easy to peel
- 100% ink transfer
- Sharp images and bright colours
- Ease of placement with Translucency (Z95 only)
- Embossed surfaces (Textured only)

Screen Printing Cold Peel Transfer

STEP 1

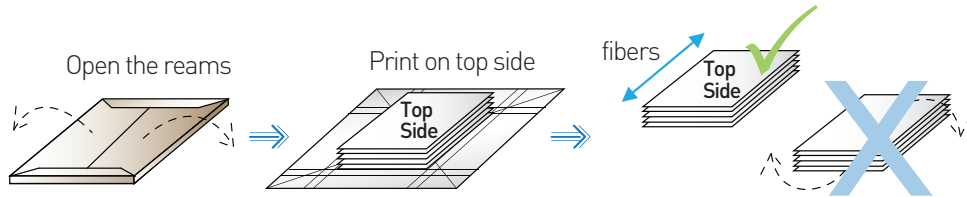

STEP 2

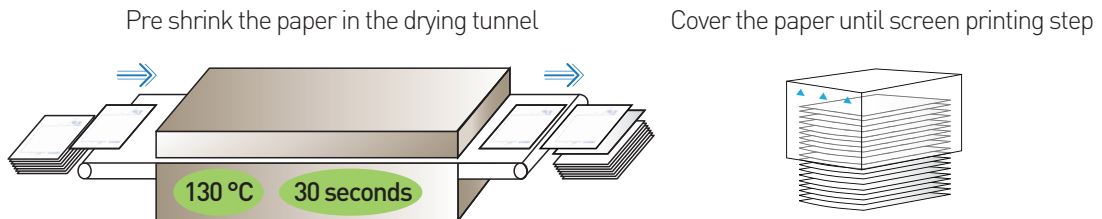

STEP 3

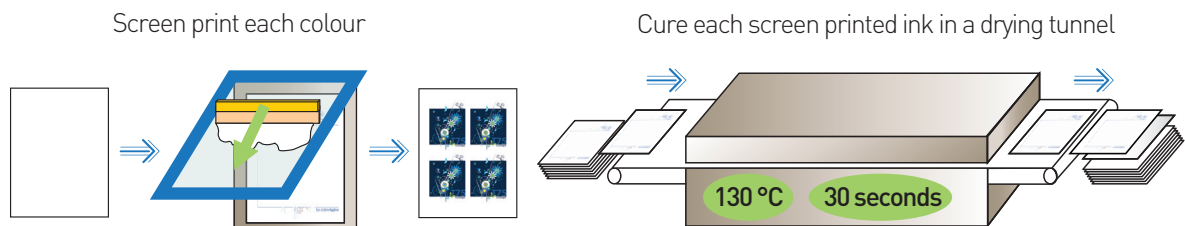

Make a rolling test to check if the curing is ok

To avoid miss registering, cover the printed sheets, in between each printed colour

To enhance washing resistance : After the last colour, and just prior entering in the drying tunnel, spray adhesive powder. Remove excess of powder by shaking

Cut and wrap the printed sheets in a sealed plastic bag

STEP 4

Heat press the design on the garment within 6 months after printing

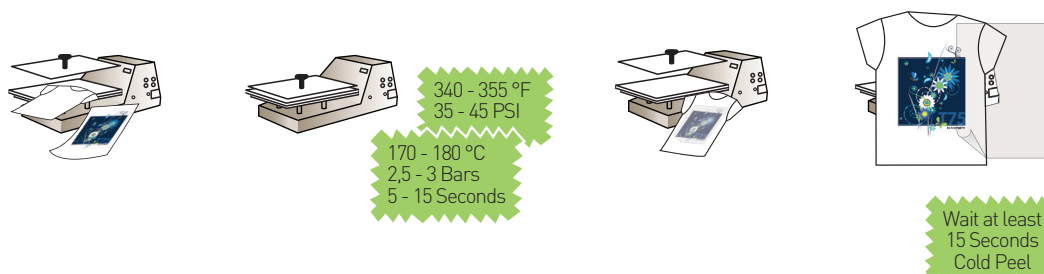

Wait at least 15 Seconds Cold Peel